

**PLASTIC RESERVOIR**

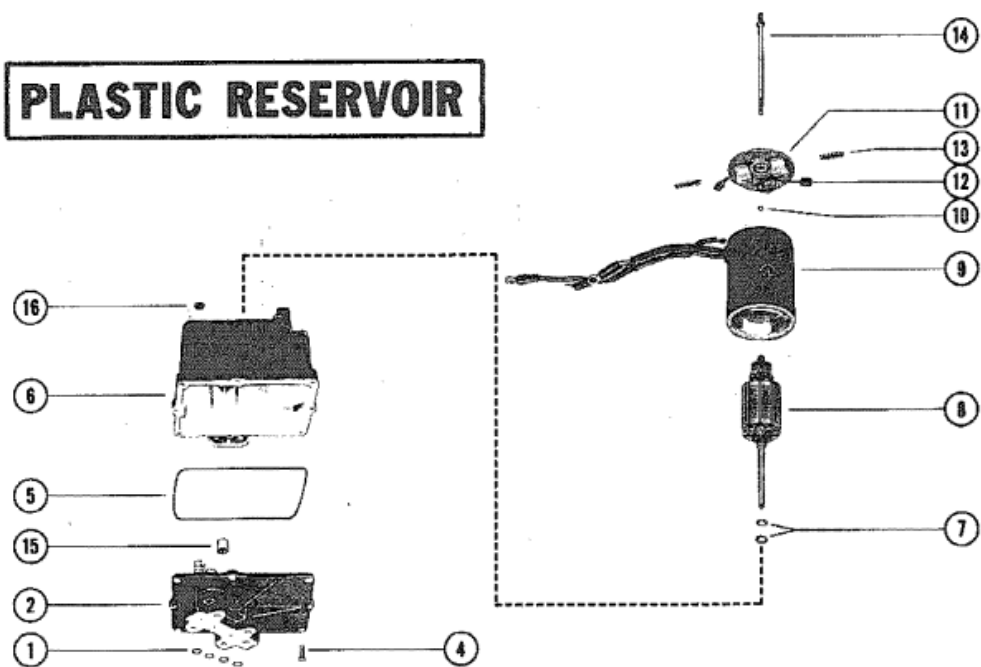

Parts List						
Ref	Class	Part	Description	Qty	Comment	Footnote
-		88475A	5 HYDRAULIC PUMP ASSEMBLY, C	1		
-		93247A	4 HYDRAULIC PUMP ASSEMBLY, C	1		
1	25	48171	"O" RING, HYDRAULIC PUMF	4		
2	392	7734	VALVE BODY AND GEAR ASSE	1		
2	392	8263	VALVE BODY AND GEAR ASSE	1		
4	10	69570	SCREW, VALVE BODY TO RESI	8,8		
5	392	7735	SEAL, RESERVOIR TO VALVE E	1,1		
6	392	7731	RESERVOIR ASSEMBLY (PLAS	1,1		
7	392	7732	WASHER, THRUST-ARMATUR	AR,AR		
8	392	7729	ARMATURE, FIELD AND FRAM	1,1		
9	392	2942	FIELD AND FRAME ASSEMBLY	1		
9	392	8261	FIELD AND FRAME ASSEMBLY	1,1		
10	392	7730	BALL, COMMUTATOR END PLAT	1,1		
11	392	2940	PLATE ASSEMBLY, COMMUTA	1		
11	392	8262	PLATE ASSEMBLY, COMMUTA	1		
12	392	2941	BRUSH SET, COMMUTATOR	1,1		
13	393	2529	SPRING SET, BRUSH TENSION	1,1		
14	392	7733	BOLT SET, THRU-PLATE AND FF	1,1		
15	392	7727	COUPLER AND SAHFT	1,1		
16	392	7728	FILL PLUG, RESERVOIR	1,1		